

ADDENDUM — RENAISSANCE RUMFORD INSTALLATION



These instructions replace the "Door and Firescreen Installation" section of the manual.

NEW installation method for the counterweights:

Openings A and C have been added to the fireplace facing. The openings will be covered by cement board and do not have finishing metal cover plates.

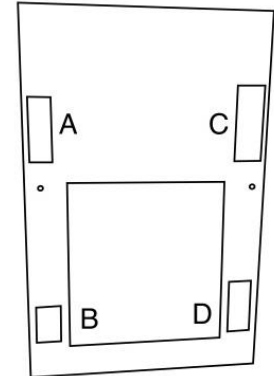

1

Start by placing the three counterweight cables through the new openings and over the pulleys. Allow the cables to hang down towards the door.



x3 counterweight
cables

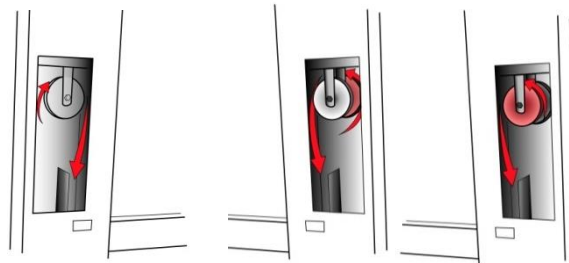

2

Place each counterweight in its respective channel opening (A or C). On the right side, the larger counterweight enters the rear channel and the smaller counterweight enters the front channel. Ensure the smaller counterweight has extended metal plate oriented towards the back of the fireplace. The counterweights are supported by pre-installed blocking rods. Ensure the blocking rods are in position before inserting the counterweights.

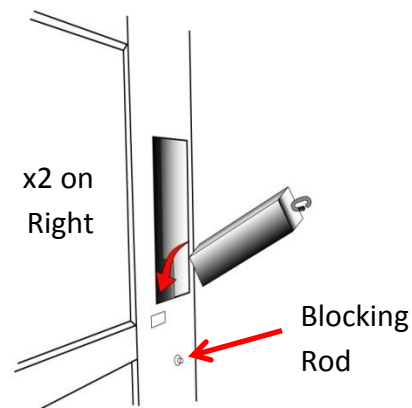
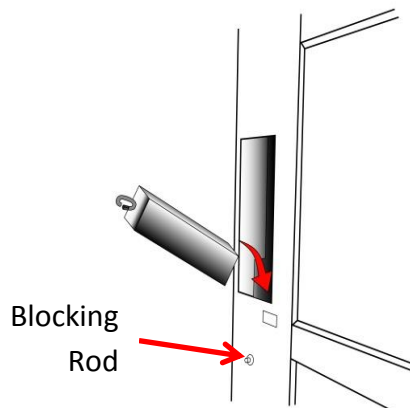

3

In three locations, connect the cables to the counterweights and tighten the nuts that hold them in place.

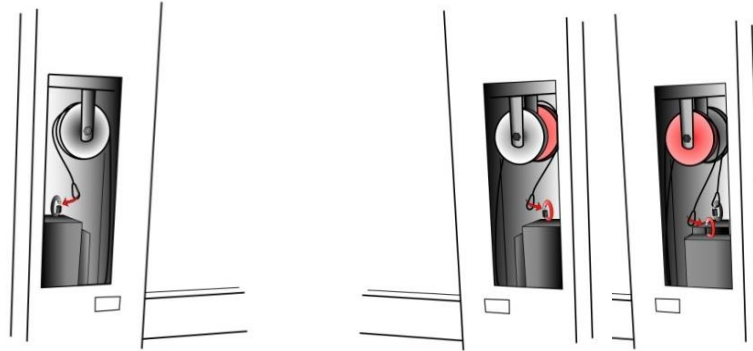

4

Connect the hanging cables to the bottom of the door and screen using openings B & D.

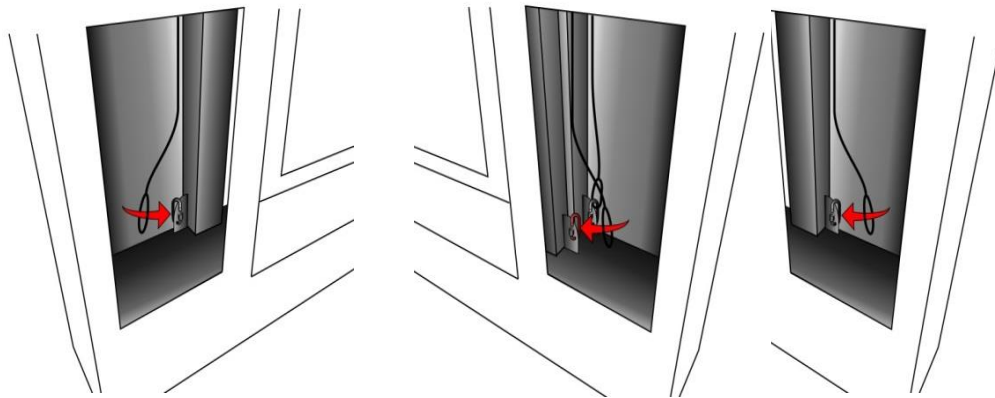

5

Using pliers, remove the four caps on the back side of the blocking rods. Through opening A, ensure the cable is on the pulley, and then grab hold of the cable and pull to lift the counterweight off the blocking rod. Remove the blocking rod. Repeat for the right side.

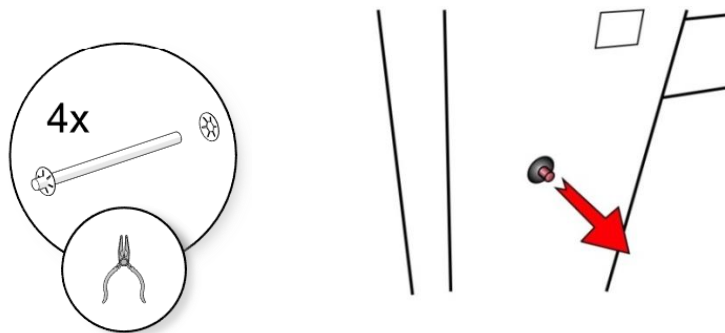

6

Slide the door /screen system up and down to verify they are functioning smoothly

If you have feedback about the new changes, please contact us at info@icc-rsf.com.